

# Flymo

# Micro Lite

 Electrolux

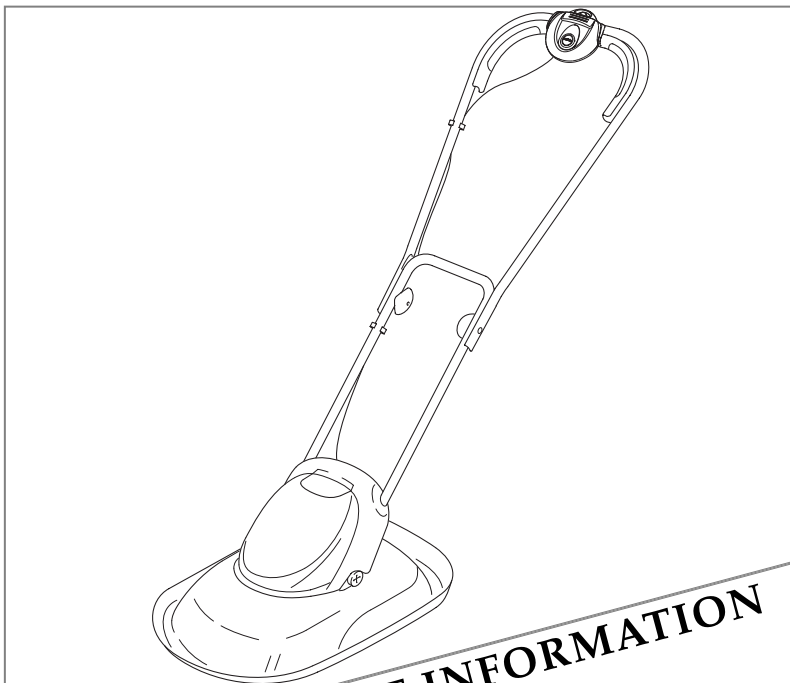

**IMPORTANT INFORMATION**  
Read before use  
& retain for future reference



For all customer enquiries or for replacement parts, contact:-

 01325 300303

 [www.flymo.com](http://www.flymo.com)

 [eop.customer.services@electrolux.co.uk](mailto:eop.customer.services@electrolux.co.uk)

## Carton Contents

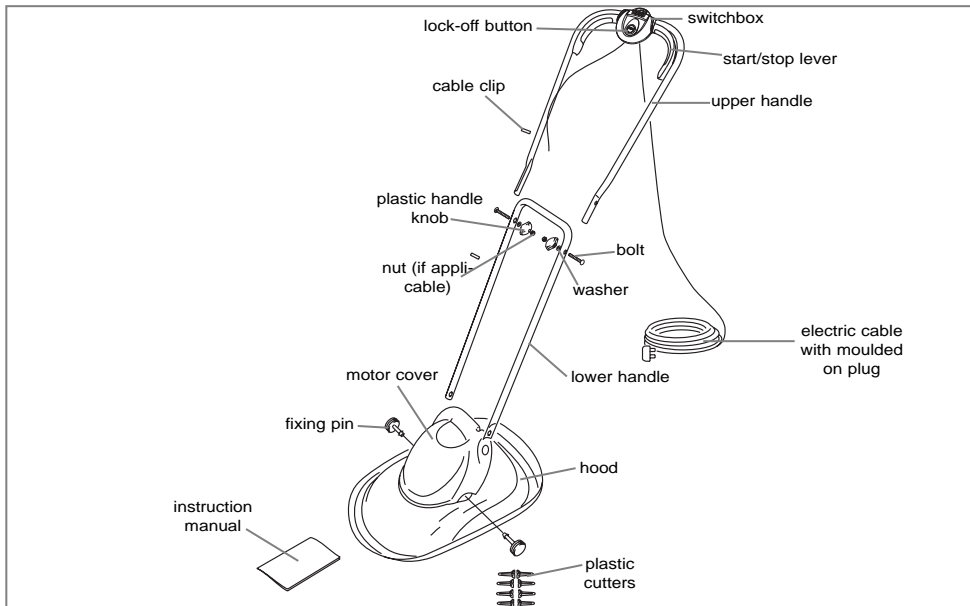

### IMPORTANT !

Please check the contents of the carton are correct **BEFORE** assembling your new Flymo product.

#### IF ANY PARTS ARE MISSING CONTACT:-

Electrolux Outdoor Products Customer Service Department direct

Telephone : 01325 300303

Fax : 01325 318193

## Safety



If not used properly this lawnmower can be dangerous! This lawnmower can cause serious injury to the operator and others, the warnings and safety instructions must be followed to ensure reasonable safety and efficiency in using this lawnmower. The operator is responsible for following the warning and safety instructions in this manual and on the lawnmower.

### Explanation of Symbols on the Micro Lite



Warning

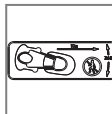

Keep bystanders away. Do not mow whilst people especially children or pets are in the mowing area.



Read the user instructions carefully to make sure you understand all the controls and what they do.



Do not mow in the rain or leave the lawnmower outdoors while raining



Switch off! Remove plug from mains before adjusting, cleaning or if cable is entangled or damaged. Keep the cable away from the plastic cutters.



The use of eye protection is recommended to protect against objects thrown by the plastic cutters.

**General**

1. Never allow children or people unfamiliar with these instructions to use the mower. Local regulations may restrict the age of the operator.
2. Only use the lawnmower in the manner and for the functions described in these instructions.
3. Never operate the lawnmower when you are tired, ill or under the influence of alcohol, drugs or medicine.
4. The operator or user is responsible for accidents or hazards occurring to other people or their property.

**Electrical**

1. The British Standards Institute recommend the use of a Residual Current Device (R.C.D.) with a tripping current of not more than 30mA. Even with a R.C.D. installed 100% safety cannot be guaranteed and safe working practice must be followed at all times. Check your R.C.D. every time you use it.
2. Before use, examine cable for damage, replace it if there are signs of damage or ageing.
3. Do not use the lawnmower if the electric cables are damaged or worn
4. Immediately disconnect from the mains electricity supply if the cable is cut, or the insulation is damaged. Do not touch the electric cable until the electrical supply has been disconnected. Do not repair a cut or damaged cable. Replace it with a new one.
5. Your cable must be uncoiled, coiled cables can overheat and reduce the efficiency of your mower.
6. Keep cable away from lawnmower, always work away from the power point mowing up and down, never in circles.
7. Do not pull cable around sharp objects.
8. Always switch off at the mains before disconnecting any plug, cable connector or extension cable.
9. Never pull on the cable to disconnect any of the plugs.
10. Switch off, remove plug from mains and examine electric supply cable for damage or ageing **before** winding cable for storage. Do not repair a damaged cable, replace it with a new one. Use only Flymo replacement cable.
11. Always wind cable carefully, avoiding kinking.
12. Never carry the product by the cable.
13. Never pull on the cable to disconnect any of the plugs.
14. Use only on AC mains supply voltage shown on the product rating label.
15. Flymo products are double insulated to EN60335. Under no circumstance should an earth be connected to any part of the product.

**Preparation**

1. While using your product always wear substantial footwear and long trousers.
2. Make sure the lawn is clear of sticks, stones, bones, wire and debris; they could be thrown by the plastic cutters.
3. Before using the machine and after any impact, check for signs of wear or damage and repair as necessary.

4. Replace worn or damaged plastic cutters together with their fixings in sets to preserve balance.

**Use**

1. Use the lawnmower only in daylight or good artificial light.
2. Avoid operating your lawnmower in wet grass, where feasible.
3. Take care in wet grass, you may lose your footing.
4. On slopes, be extra careful of your footing and wear non-slip footwear.
5. Mow across the face of slopes, never up and down.
6. Exercise extreme caution when changing direction on slopes. Walk never run.
7. Mowing on banks and slopes can be dangerous. Do not mow on **banks** or **steep** slopes.
8. Do not walk backwards when mowing, you could trip.
9. Never cut grass by pulling the mower towards you.
10. Switch off before pushing the mower over surfaces other than grass.
11. Never operate the lawnmower with damaged guards or without guards in place.
12. Never carry the product by the cable.
13. Keep hands and feet away from the cutting means at all times and especially when switching on the motor.
14. Do not tilt lawnmower when the motor is running, except when starting and stopping. In this case, do not tilt more than absolutely necessary and lift only the part which is away from the operator. Always ensure that both hands are in the operating position before returning the appliance to the ground.
15. Never pick up or carry a mower when it is operating or still connected to the mains supply.
16. Remove the plug from the mains :
  - before leaving the mower unattended for any period;
  - before clearing a blockage;
  - before checking, cleaning or working on the appliance;
  - if you hit an object. Do not use your lawnmower until you are sure that the entire lawnmower is in a safe operating condition.;
  - if the lawnmower starts to vibrate abnormally. Check immediately. Excessive vibration can cause injury.

**Maintenance and storage**

1. Keep all nuts, bolts and screws tight to be sure the lawnmower is in safe working condition.
2. Replace worn or damaged parts for safety.
3. Only use the replacement plastic cutters specified for this product.
4. Be careful during adjustment of the lawnmower to prevent entrapment of the fingers between moving plastic cutters and fixed parts of the machine.

**CABLES****IMPORTANT**

- Use only 1.00mm<sup>2</sup> size cable up to 30 metres length maximum.

**Maximum rating :**

1.00mm<sup>2</sup> size cable, 10 amps 250 volts AC.

- **THE MICRO LITE IS SUPPLIED WITH CABLE WIRED DIRECTLY INTO THE PRODUCT.**

1. Flymo Mains Cables and Extension Cables are available from your local Electrolux Outdoor Products Approved Service Centre.
2. Do not wire an extension cable directly to your product yourself. Please contact your local Electrolux Outdoor Products Approved Service Centre for further information on the connectors and kits available.
3. Only use extension cables specifically designed for outdoor use.

**CONNECTORS****IMPORTANT**

- Flymo connectors are suitable for use with 2 core cable only. Under no circumstances should these connectors be used for earthed products.
- All Flymo connectors and cables are of splash-proof construction. They are not waterproof and must not be left outside permanently nor should they be submerged or immersed in water. Do not let cable lay or trail through pools of water or splashed with water from hose pipes.

**MAINS PLUG REPLACEMENT****IMPORTANT**

- **If the plug supplied is cut off it should be destroyed. There is an electric shock hazard if a cut off plug is inserted into a 13 amp socket.**
1. **No earth required.** Flymo products are double insulated to EN60335 and under no circumstances should an earth be connected to any part of the product.

2. **Ensure the mains voltage suits your product**
3. **IMPORTANT!**

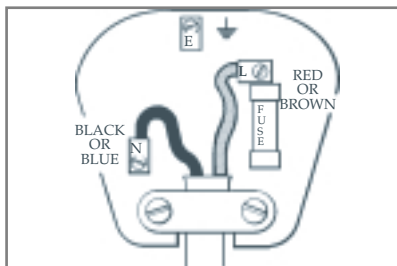

The wires in the mains lead are coloured in accordance with the following code:

BLUE - NEUTRAL

BROWN - LIVE

The wire which is coloured BLUE must be connected to the Terminal which is marked with the letter 'N' or coloured BLACK.

The wire which is coloured BROWN must be connected to the Terminal which is marked with the letter 'L' or coloured RED.

4. It is important that the outer sheath is clamped correctly into the 3-pin plug.
5. If in doubt consult your local Service Repairer or qualified electrician before the machine is used.
6. **A 13 Amp fuse must be fitted to the Mains Plug.**
7. The normal plug fuse and household fuse only protect the electrical equipment and are not a safeguard against electrocution.

**If your product is hard wired i.e. non-detachable mains electric cable, a conversion kit and extension cable is available from all Electrolux Outdoor Products Approved Service Centres which can be found in your local Yellow Pages.**

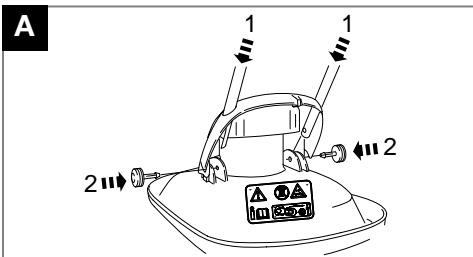
**Assembly Instructions****Lower Handle to Hood Assembly (A)**

- **Ensure the motor cover is fitted correctly, as illustrated**
  - **Tilt and lock motor cover into forward position before assembly**
1. Insert lower handles through the 2 holes in the motor cover and push down.
  2. Secure lower handles to hood by firmly pushing fixing pins through holes in motor cover, handle and hood.

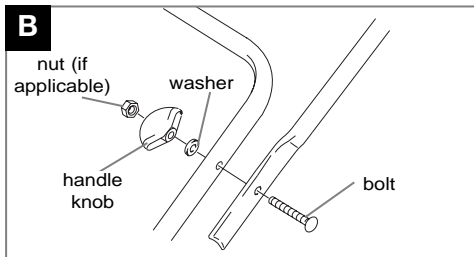
**Fitting Upper Handles to Lower Handles (B)**

1. Ensure the upper handle is located correctly with the lock-off button on the switchbox uppermost
2. Ensure the upper handle and the lower handle are aligned correctly.
3. Insert the nut into the handle knob. (if applicable)
4. Fit the bolts, washers and handle knobs.
5. Fit the cable to the handles with the clips provided. Make sure the cable is not trapped between the handles.

## Starting and Stopping

### To Start your Lawnmower

1. Form loop in mains cable and push the loop through the slot as illustrated in picture (C)
  2. To secure, position loop over the hook and pull the cable back through the slot as illustrated in picture (D).
  3. Connect plug to mains.
  4. Move handle to the mowing position. **See Fig. E.**
  5. To prevent a ring being cut in your lawn, tilt your lawnmower slightly (E).
- **The switchbox is provided with a lock-off button (F1) to prevent accidental starting.**
6. Press and hold the lock-off button (F) on the switchbox, then squeeze one of the Start/Stop levers towards the upper handle (G).
  7. Continue to squeeze the start/stop lever towards the upper handle and release the lock-off button. (H)
  8. When the lawnmower has reached full speed gently lower it onto the lawn.
- **NOTE**  
There are two start/stop levers fitted. Either one can be used for starting the lawnmower.
  - **IMPORTANT**  
Do not use the start/stop levers intermittently

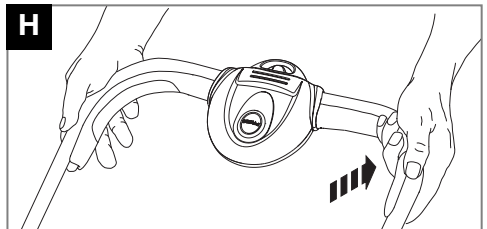
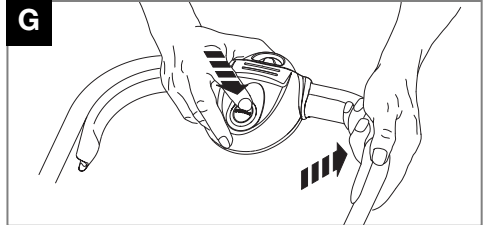
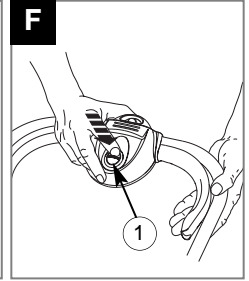
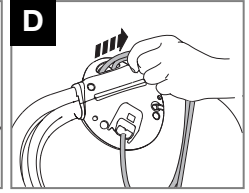
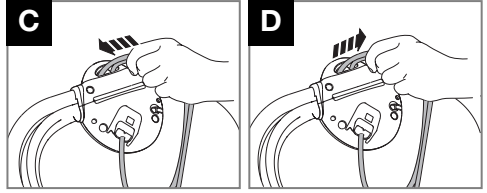

### To Stop your Lawnmower

1. To prevent a ring being cut in your lawn, tilt your lawnmower slightly (E).
2. Release the pressure on the Start/Stop lever.

## How to Mow

1. Start mowing the edge of the lawn nearest to the power point so that the cable is laid out on the lawn you have already cut. (J)
2. Mow twice a week in the growing season, your lawn will suffer if more than one third of its length is cut at one time.

### Do not Overload your Lawnmower

Mowing long thick grass may cause the motor speed to drop, you will hear a change in the motor sound. If the motor speed drops you may overload your lawnmower which may cause damage. When mowing in long thick grass, a first cut with the cutting height set higher will help reduce the load. See Adjusting the Cutting Height.

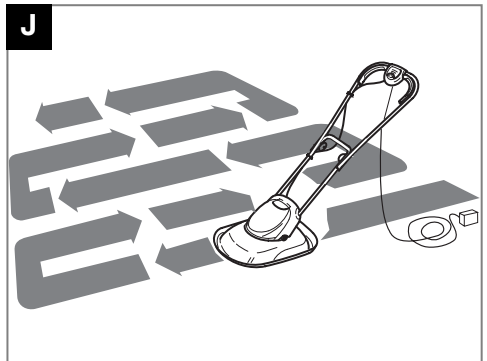

## Adjusting the Cutting Height & Cutting System Maintenance

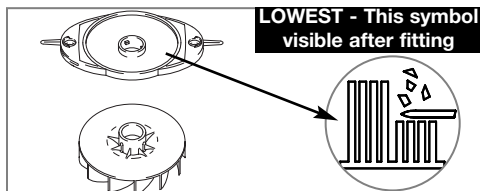
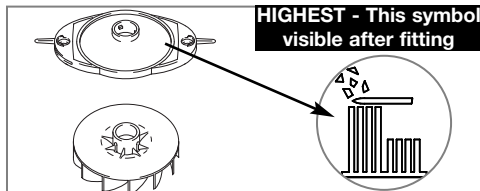

- **THERE ARE 2 CUTTING HEIGHTS**
- **Height of cut is adjusted by turning over the cutting head.**
- Disconnect from the mains electricity supply and wait until the cutting head has stopped rotating. Turn your lawnmower upside down.

### To Remove the Cutting Head and Fan (K)

1. Hold the fan firmly and twist the cutting head anti-clockwise as illustrated.
2. Hold the cutting head in the centre and remove as illustrated.
3. Hold fan in the centre and remove as illustrated.
4. Inspect for damage and clean as necessary.

### To Refit the Fan and the Cutting Head (L)

1. Replace the fan as illustrated.
2. Replace the cutting head, adjusting the height of cut as required.
3. Hold the fan firmly and twist the cutting head clockwise, as illustrated.

### IMPORTANT

**ENSURE FAN AND CUTTING HEAD ARE CORRECTLY LOCATED**

- **Always handle the plastic cutters with care - sharp edges could cause injury. USE GLOVES.**

### Checking your Cutting System (M)

- The cutting system must be kept in good condition and inspected before and after use.
- Disconnect from the mains electricity supply and wait until the cutting head has stopped rotating. Turn your lawnmower upside down.

1. Visually check cutting head for wear. Replace if damaged.
2. Visually check plastic cutters for wear and replace when necessary.
3. Plastic cutters should be straight. Replace if bent or twisted.

### Replacing Plastic cutters

- Use only genuine Flymo replacement plastic cutters specified for this product. These are available from all Electrolux Outdoor Products Service Centres and major retail outlets.
- Plastic cutters must be replaced in pairs to retain balance.
- Two plastic cutters of the same type should be fitted.
- **Never fit a steel bar blade to this product.**
- **To Replace Plastic Cutters**
- Disconnect from the mains electricity supply and wait until the cutting head has stopped rotating. Turn your lawnmower upside down.
- 1. Push plastic cutter towards centre of cutting disc. Lift plastic cutter away from cutting head. **(N)**
- 2. If the plastic cutter is broken during use - lever cutter out of the slot, and dispose of carefully.
- 3. Fit new plastic cutters into the slots at each side of the cutting head and pull into place. **(P)**

- **IMPORTANT ENSURE PLASTIC CUTTERS ARE CORRECTLY LOCATED.**

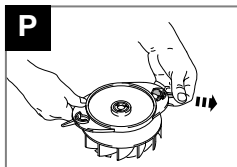
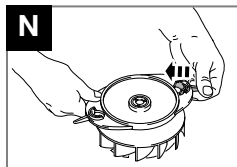
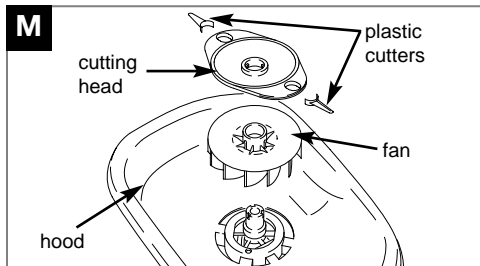
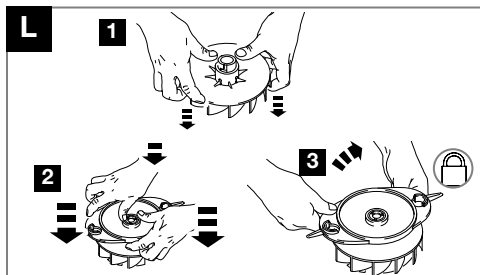
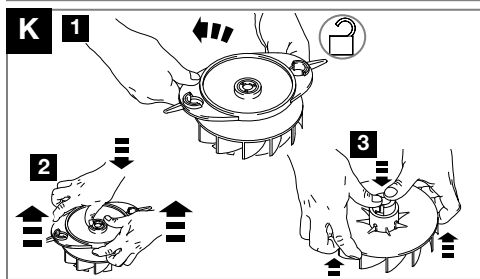

## Caring for your Lawnmower

- **It is very important that you keep your lawnmower clean. Grass clippings left in any of the air intakes or under the hood could become a potential fire hazard**

### Cleaning (Q)

1. Remove grass from under the hood with a piece of wood or similar.
  2. Using a soft brush - remove grass clippings from all air intakes.
  3. Remove the cutting head, (see fig K), to gain access to the fan and clean with a soft brush.
  4. Wipe over the surface of your lawnmower with a dry cloth.
- **IMPORTANT:** Never use water for cleaning your lawnmower. Do not clean with chemicals, including petrol, or solvents - some can destroy critical plastic parts.

### At the End of the Mowing Season

1. Replace plastic cutters, bolts, nuts or screws, if necessary.
2. Clean your lawnmower thoroughly.
3. Ask your local Service Centre to clean the air filter thoroughly and carry out any service or repairs required.
4. Make sure that the electric cable is coiled properly.

**Carrying your Lawnmower:** Hold as illustrated in Figure R. Ensure the blade is facing away from you.

**Storing your Lawnmower (S):** Store in a dry place where your lawnmower is protected from damage.

Q

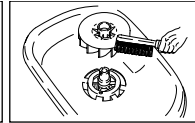
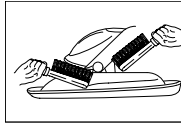
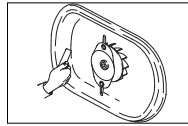

R

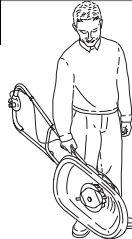

S

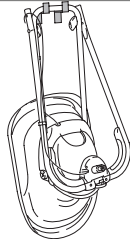

## Fault Finding Hints

### Fails to Operate

1. Is the Power Turned On?
2. Check the fuse in the plug, if blown replace.
3. Fuse continues to blow?

**Immediately disconnect from the mains electricity supply and consult your local approved Service Centre.**

### Poor Flotation

1. Disconnect from the mains electricity supply.
2. Clean the underside of the hood and the fan blades.
3. Raise to a higher height of cut. See Adjusting the Cutting Height.

4. If poor flotation persists?

**Disconnect from the mains electricity supply and consult your local approved Service Centre.**

### Excessive Vibration

1. Disconnect from the mains electricity supply.
2. Replace broken or missing plastic cutters.
3. Check plastic cutters and cutting head are fitted correctly and securely located.
4. If vibration persists?

**Immediately disconnect from the mains electricity supply and consult your local approved Service Centre.**

## Service Recommendations

1. We strongly recommend that your product is serviced at least every twelve months, more often in a professional application.
2. Always use genuine Flymo Spare Parts.
3. Prepacked spares are available from most Electrolux Outdoor Products stockists.
4. Your product is uniquely identified by a silver and black product rating label
5. If you have a problem with your machine contact your local Approved Service Centre ensuring you have full details of your product as described on the product rating label.
6. **Should it be necessary for work to be carried out by your Service Centre, it is important to take your complete machine including cable and any extension cables used.**

A network of specialist dealers can be found in your local Yellow Pages.

To obtain service on your Flymo product simply telephone or visit your local Service Centre.

Should you require service under the terms of our guarantee the Service Centre will require proof of purchase.

**All of the centres listed stock genuine Flymo Spare Parts.**

### NOTE:

**Our Service Repairers act on their own behalf and are not empowered to commit or legally bind Electrolux Outdoor Products in any manner whatsoever.**

## Environmental Information

Electrolux Outdoor Products are manufactured under an Environmental Management System (ISO 14001) using, where practical, components manufactured in the most environmentally responsible manner, according to company procedures, and with the potential for recycling at the end of the products' life.

- Packaging is recyclable and plastic components have been labelled (where practical) for categorised recycling.
- Awareness of the environment must be considered when disposing of 'end-of-life' product.
- If necessary, contact your local authority for disposal information.

## Guarantee & Guarantee Policy

If any part is found to be defective due to faulty manufacture within the guarantee period, Electrolux Outdoor Products, through its Authorised Service Repairers will effect the repair or replacement to the customer free of charge providing:

- (a) The fault is reported directly to the Authorised Repairer.
  - (b) Proof of purchase is provided.
  - (c) The fault is not caused by misuse, neglect or faulty adjustment by the user.
  - (d) The failure has not occurred through fair wear and tear.
  - (e) The machine has not been serviced or repaired, taken apart or tampered with by any person not authorised by Electrolux Outdoor Products.
  - (f) The machine has not been used for hire.
  - (g) The machine is owned by the original purchaser.
  - (h) The machine has not been used outside of the country for which it was specified.
  - (i) The machine has not been used commercially.
- \* This guarantee is additional to, and in no way diminishes the customers statutory rights.

Failures due to the following are not covered, therefore it is important that you read the instructions contained in this Operator's Manual and understand how to operate and maintain your machine:

### Failures not covered by guarantee

- \* Replacing worn or damaged plastic cutters
- \* Failures as a result of not reporting an initial fault.
- \* Failures as a result of sudden impact.
- \* Failures as a result of not using the product in accordance with the instructions and recommendations contained in this Operator's Manual.
- \* Machines used for hire are not covered by this guarantee.
- \* The following items listed are considered as wearing parts and their life is dependent on regular maintenance and are, therefore not normally subject to a valid warranty claim: Plastic Cutters, Electric Mains cable.
- \* **Caution!**  
Electrolux Outdoor Products does not accept liability under the warranty for defects caused in whole or part, directly or indirectly by the fitting of replacement parts or additional parts that are not either manufactured or approved by Electrolux Outdoor Products, or by the machine having been modified in any way

## EC Declaration of Conformity

I, the undersigned M. Bowden of Electrolux Outdoor Products, Aycliffe Industrial Park, **NEWTON AYCLIFFE**, Co. Durham. DL5 6UP. Certify that the product:-  
Category..... **Electric Hover**  
Make..... **Electrolux Outdoor Products**  
Conforms to the specifications of Directive 2000/14/EEC

I, the undersigned M. Bowden of Electrolux Outdoor Products, Aycliffe Industrial Park, **NEWTON AYCLIFFE**, Co. Durham. DL5 6UP. Certify that a sample of the above product has been tested using directive 81/1051/EEC as a guide. The maximum A-weighted sound pressure **level** recorded at operator position under free field semi anechoic chamber conditions was :-

I, the undersigned M. Bowden of Electrolux Outdoor Products, Aycliffe Industrial Park, **NEWTON AYCLIFFE**, Co. Durham. DL5 6UP. Certify that a sample of the above product has been tested using ISO 5349 as a guide. The maximum weighted root mean square **value** of vibration recorded at operator's hand position was:-

Type of Cutting Device..... <b>Plastic Blade</b> Identification of Series..... <b>See Product Rating Label</b> Conformity Assessment Procedure..... <b>ANNEX VI</b> Notified Body..... <b>I.T.S., Cleeve Road, Leatherhead, Surrey. KT22 7SB England</b> Other Directives:-..... <b>98/37/EEC, 89/336/EEC, 73/23/EEC</b> & applicable standards:-. <b>EN60555-2:1987, EN60555-3:1987, EN55014:1993, EN55014:1995, EN836:1997, IEC335-1:1991, IEC335-2:1977:1996</b>	Type ..... <b>A</b> Width of Cut ..... <b>B</b> Speed of Rotation of Cutting Device ..... <b>C</b> Guaranteed sound power level ..... <b>D</b> Measured Sound Power Level ..... <b>E</b> Level ..... <b>F</b> Value ..... <b>G</b> Weight ..... <b>H</b>
--	---

A	<b>MLite 28</b>
B	<b>28 cm</b>
C	<b>7,250 RPM</b>
D	<b>96 dB (A)</b>
E	<b>96 dB (A)</b>
F	<b>84.1 dB(A)</b>
G	<b>1.21 m/s<sup>2</sup></b>
H	<b>4.5 kg</b>



Newton Aycliffe, 16/12/2002  
M. Bowden,  
Research & Development Director

Electrolux Outdoor Products  
Aycliffe Industrial Park  
**NEWTON AYCLIFFE**  
Co.Durham DL5 6UP  
**ENGLAND**

**Telephone - (00) 44 1325 300303 Fax - (00) 44 1325 310339**

Our policy of continuous improvement means that the specification of products may be altered from time to time without prior notice. Electrolux Outdoor Products manufacture products for a number of well known brands under various registered patents, designs and trademarks in several countries.

© Electrolux Outdoor Products Ltd. Registered Office, Electrolux Works, Oakley Road, Luton LU4 9QQ  
Registered number 974979 England

 **The Electrolux Group. The world's No.1 choice.**

The Electrolux Group is the world's largest producer of powered appliances for kitchen, cleaning and outdoor use. More than 55 million Electrolux Group products (such as refrigerators, cookers, washing machines, vacuum cleaners, chain saws and lawn mowers) are sold each year to a value of approx. USD 14 billion in more than 150 countries around the world.

**5119422-01**

